

What every agent has been made to ensure the accuracy of the floorplan contained here, measurements of doors, windows, rooms and other features are approximate and responsibility is taken by the prospective purchaser. The floorplan is intended for guidance only and should be used as such by the prospective purchaser. The floorplan is not intended to be used as a contract and no guarantee as to their accuracy or efficiency can be given.  
 Made with floorplan 10/2021

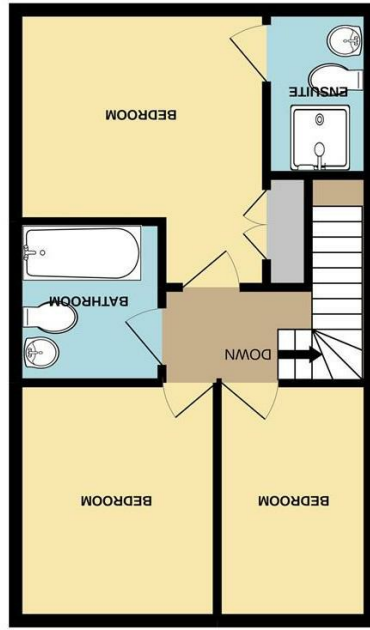

1ST FLOOR  
 38.9 sq.m. (419 sq.ft.) approx.



GROUND FLOOR  
 38.9 sq.m. (419 sq.ft.) approx.

England & Wales	
EU Directive 2002/91/EC	
Not energy efficient - higher running costs	
(1-20)	G
(21-30)	F
(31-40)	E
(41-50)	D
(51-60)	C
(61-70)	B
(71-80)	A
Very energy efficient - lower running costs	
(81-91)	84
(92 plus)	84
Potential	

Energy Efficiency Rating



Norfolk Property  
 online.

Willowcroft Way | Norwich | NR4  
**Guide price £270,000**

Norfolk Property Online are pleased to offer this beautifully presented family home situated on a popular modern development. The property offers 3 first floor bedrooms, en suite to master and family bathroom, whilst the ground floor includes a large lounge diner with garden access, plus stylish kitchen and WC. Outside benefits from a single driveway with garage and enclosed rear garden. This property is located in a prime position on the development within walking distance of the park.

Guide price £270,000-£280,000

